

Winnebago LeSharo

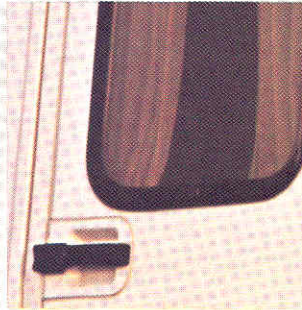

How to be sure a motor everyday use isn't filled

- ☐ Aerodynamic profile.
- ☐ Steel unibody construction.
- ☐ Insulated Thermo-panel sidewalls and roof.
- ☐ Dual batteries with switch.
- ☐ Extra-wide rear axle.
- ☐ Rack and pinion steering.
- ☐ Entrance door curtain.
- ☐ Gasoline engine with automatic transmission or turbocharged diesel engine with four speed manual transmission.*
- ☐ Fuel injection.
- ☐ Front wheel drive.
- ☐ Engine block heater.
- ☐ Power steering.
- ☐ Door trim panels with map pockets.
- ☐ MacPherson strut front suspension.
- ☐ Rear mud flaps.
- ☐ Exterior power cord.
- ☐ Reclining front bucket seats.
- ☐ Automotive air conditioning.
- ☐ Running boards.
- ☐ Sewer hose storage compartment.
- ☐ Exterior lamps.
- ☐ Lockable fuel cap and water fill door.
- ☐ Tinted windows.
- ☐ 2,000-watt generator.
- ☐ 7,100-BTU roof air conditioner.
- ☐ Screen door.
- ☐ Television antenna.
- ☐ Front wraparound privacy curtain.
- ☐ Power door locks.
- ☐ Cruise control.
- ☐ Split-level floorplan.
- ☐ Stand-up headroom.
- ☐ Sunvisors.
- ☐ Dual roof vents.
- ☐ Two lighted beverage holders/ashtrays.
- ☐ Power stove vent.
- ☐ Stainless steel sink.
- ☐ Refrigerator.
- ☐ Two-burner range.
- ☐ Converter/battery charger.



home that's designed for with everyday features.

- ☐ 20,000-BTU electronic ignition furnace.
- ☐ Bathroom skylight.
- ☐ 6-gallon electric water heater.
- ☐ Deluxe monitor panel.
- ☐ 110-volt exterior outlet.
- ☐ Lockable spare tire cover.
- ☐ Decorative window coverings.
- ☐ Rearview mirrors.
- ☐ Courtesy lights.
- ☐ Dome lights.
- ☐ Passenger visor light.
- ☐ 5-B:C fire extinguisher.
- ☐ Lighted wardrobe.
- ☐ Wire wheel covers or cast alloy wheels.
- ☐ Steel belted radial tires.
- ☐ Emergency start solenoid.
- ☐ Inside rearview mirror.
- ☐ Full action-back carpeting.

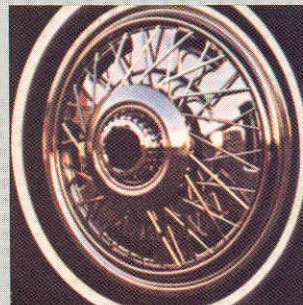

- ☐ Battery condition gauge.
- ☐ Oak beverage tray.
- ☐ Companion lounge seats.
- ☐ Bedding shelf.
- ☐ Full length mirror.
- ☐ Room divider curtain.
- ☐ Deluxe AM/FM/cassette stereo system.
- ☐ Tachometer.
- ☐ Brushed brass-tone bathroom accessories.
- ☐ Medicine cabinet.
- ☐ Direct drive water pump.
- ☐ Shower.
- ☐ Sport steering wheel.
- ☐ Towel bar.
- ☐ Rear automotive heater.
- ☐ Heavy duty suspension.
- ☐ Overhead cabinets with oak stile and rail doors.
- ☐ Silverware drawer.
- ☐ Padded window valences.

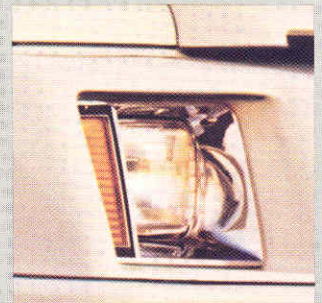

Some of the features listed above are optional or not available on all models. For a complete list of standard and optional features, see pages titled "LeSharo floorplans and specifications."

*Diesel engine not available in California.

The first motor home that works as hard on weekdays as

LeSharo® gives you all of the advantages of a Winnebago in a vehicle that's designed for a lot more than just motor homing.

So while it is ideal for special occasions, it's also perfect for everyday use.

Like a motor home, LeSharo is a true vacation vehicle. It has comfortable lounge chairs for relaxing and enough beds to sleep four. It has a kitchen for whipping up meals and a dinette for polishing them off. There's even an on-board bathroom. And LeSharo is designed to be fully self-contained. So you can live on the road just as you can in a full-sized motor home.

But unlike an ordinary motor home, LeSharo is low and lean. With its front wheel drive, rack and pinion steering and MacPherson strut front suspension, Motor Home magazine said it "corners... like a sports car." An aerodynamic steel front end and aluminum-covered sidewalls give strength and light weight to its sleek body.

LeSharo also gives you the choice of either a fuel-injected gasoline engine with a three speed automatic transmission or a turbo-charged diesel engine with a four speed manual.

Then there's its unbelievable mileage estimate—22 mpg on the highway with the turbo-charged diesel engine. Not only does it make LeSharo the most efficient motor home ever built, it makes LeSharo more efficient than many vans and several passenger cars.

The 22 mpg estimate was determined under actual driving



it plays on weekends.







conditions, not in a laboratory. The United States Auto Club independently tested a prototype vehicle across 3,142 miles of American highways, with constantly varying road grades and conditions.*

With its efficiency and drivability, LeSharo is one motor home that doesn't have to spend Monday through Friday sitting in the driveway. It makes an ideal vehicle for car-pooling, grocery shopping or simply getting around town. At less than 20 feet long, it's nearly as easy to parallel park as a station wagon.

When the weekend rolls around, LeSharo really rolls into action. And weekends are just the beginning. You can take LeSharo anywhere, any time. It is perfect for vacations or holidays, or even trips to see friends or relatives. It even makes a unique extra bedroom when you get there. Just plug in the power cord and you'll have electricity for lights, kitchen appliances, even air conditioning.

In all, it might seem hard to believe Winnebago engineers could design such an efficient and comfortable vehicle in such a short period of time. But they did.

In a little more than two years their eight-million-dollar investment produced a driving machine which took the pleasures of motor homing and cut them down to size.

And in the process, created something that's going to be very big.

*Your mileage may vary. The prototype was identical to a LeSharo without a sink, range, refrigerator and marine toilet. Although the testing achieved an average rating of 24.11 mpg, added weight could lower diesel mileage to 22 mpg. Mileage with the gas engine will be somewhat less.

Inside, LeSharo's not just a motor home. It's a miracle.





It's not LeSharo's high mileage that is really so amazing. It's that it gets that kind of efficiency without giving anything up.

You can choose LeSharo with either of two floorplans, depending on your needs. The LeSharo 220RD has a center bathroom and shower, a rear dinette and two companion lounge seats. The 220RC has a rear corner bath and a mini rear dinette.

Both models have a complete galley, with everything necessary for preparing snacks or meals. There's a two-burner gas stove, stainless steel sink and a two-cubic-foot 12-volt refrigerator.

Throughout the interior, you'll find the kind of attention to detail that has made Winnebago famous. Overhead cabinets, a lighted closet in the 220RC and storage compartments under the companion seats provide ample room for your gear. A monitor panel keeps you updated on LeSharo's various systems. There is even an oak beverage tray in the cab.

All fabrics, carpeting and furnishings combine for a rich, inviting decor. Screened windows provide plenty of cross-ventilation. For warmer weather, both automotive air conditioning and a roof air conditioner are available.

In all, LeSharo gives you more than you would expect from almost any vehicle.

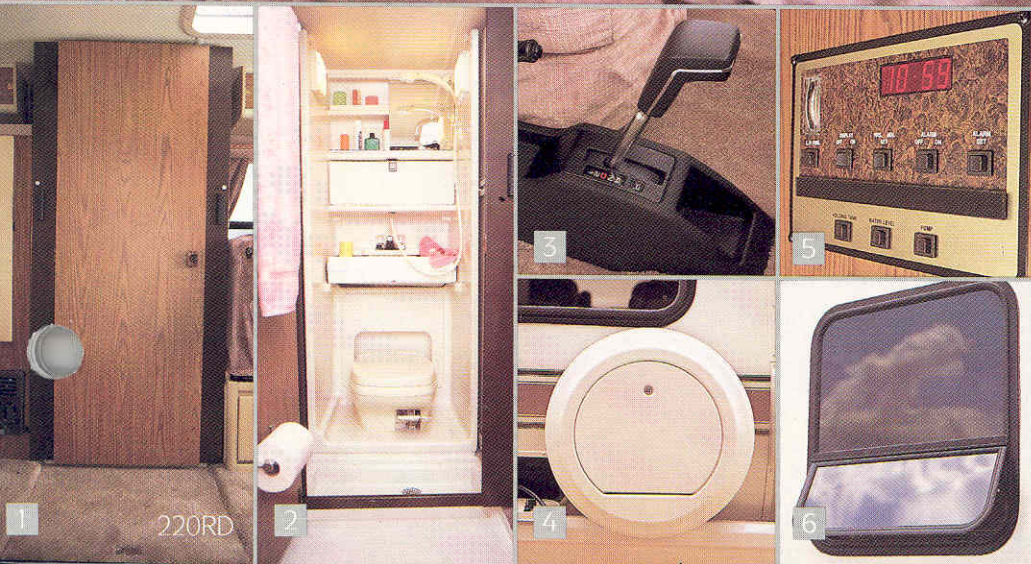

1. Space saving bathroom slides out of way...
2. ...but opens wide when you need it.
3. Automatic transmission complements the gas engine.
4. ABS spare tire cover.
5. Optional deluxe monitor panel.
6. Tilt-out screened windows.

The end of conventional thinking, inside and out.

To build a motor home like LeSharo requires much more than just conventional thinking. It requires imaginative thinking.

The advantage of LeSharo's front wheel drive, for instance, is not merely the road-hugging traction it affords the driver. It also allows for a unique split level floorplan which has a six-foot ceiling in the middle, where you stand, and a lower ceiling on the ends, where you sit.

And since there are no heavy drive line components, LeSharo's floor at the entrance door is only eleven inches off the ground. For comparison, the floor of a typical van is 27 inches above the ground. You don't climb into LeSharo, you step into it.

LeSharo's bathroom is worth closer examination as well. In the 220RD, it can be "stored away" when not in use. But by simply pulling the walls out, it suddenly becomes a completely private bathroom with a toilet, lavatory and full stand-up shower.

Up front, LeSharo's cockpit is made for the simple pleasures of driving. It offers the comfort of reclining bucket seats and power steering, plus several options from cruise control and power door locks, to a deluxe AM/FM/cassette stereo system.

So if you're looking for a vehicle that you can take across country as easily as you can take across town, take a look at LeSharo.

It's one unbelievable Winnebago.

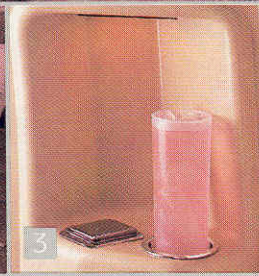

1. Convertible mini dinette.
2. Optional 2.5KW generator.
3. Recessed beverage holder/ash tray.
4. Optional cast alloy wheels.

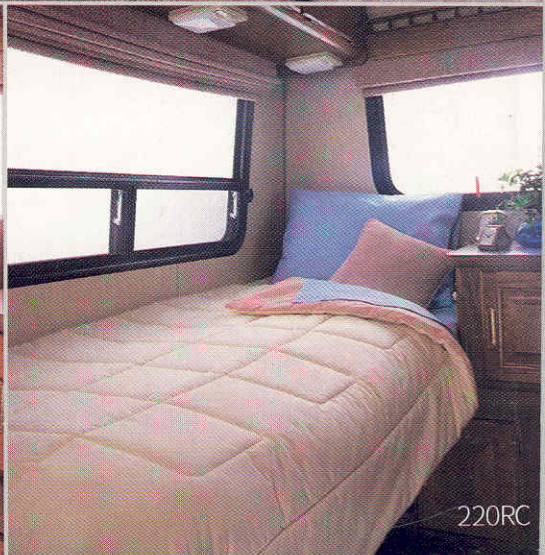

When a motor home has this much beneath it, there can be

❑ Aerodynamic front end of steel and fiberglass.

❑ Unibody steel construction for strength and integrated design.

❑ Computer aided design perfects new designs to within hundredths of an inch.

❑ Computer programmed load and stress analyses ensure proper balance and handling.

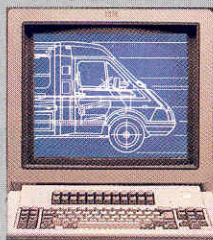

❑ Front wheel drive for improved efficiency and handling.

❑ Entire steel body dipped in a series of electro-deposition primer and sealant tanks for a smooth finish and anti-corrosive protection, bonded into every seam and curve with a 400-volt electrical charge.

❑ PVC rockguard coating applied to critical surfaces to protect the finish from gravel and other road hazards.

❑ Light yet strong aluminum frame around living areas.



11

10

❑ MacPherson strut front suspension.

❑ Available heavy-duty suspension with gas models.

❑ Automatic transmission microprocessor on the gas engine monitors engine speed and shifts transaxle for optimum performance.

❑ Optional engine block heater.

❑ Power-assisted front disc/rear drum brakes.

❑ Steel body welded with over 300 precision welds performed by a high speed, computer controlled welder.



e only one name behind it.

☐ Color-coded electrical wiring mounted in harnesses for easy maintenance.

☐ Seamless holding tanks.
☒ 9 Extra-wide rear axle.

☐ Spot welding technology used to build steel cab and chassis for the strongest possible construction.

☒ 11 Winnebago's advanced Thermo-Panel® sidewalls combine polystyrene foam, rugged steel tubing, fiber reinforced plastic (FRP), and other materials to provide lightweight strength and superior insulation.

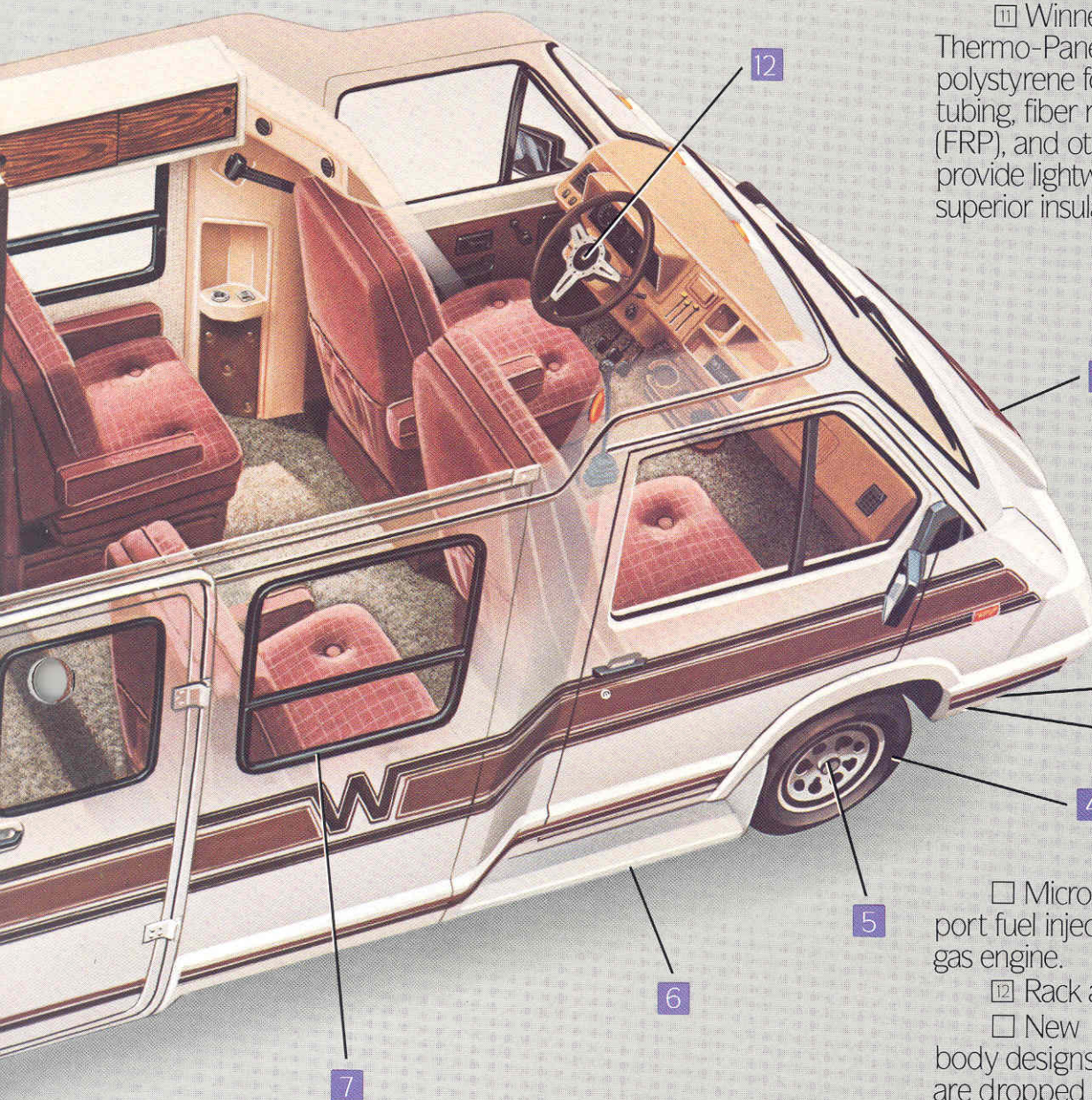

☒ 7 Electrostatically painted aluminum window and door trim, extruded in the factory to Winnebago's own specifications.

☒ 8 Steel-belted radial tires.
☐ Ignition microprocessor for spark ignition and timing in gas engine.

☐ Construction meets or exceeds all federal and state safety codes, as well as the safety codes of the Recreational Vehicle Industry Association.

☒ 10 Paint is baked on for a durable, gleaming finish.
☐ Standard limited warranty or optional 5 year/50,000 mile Traveler's Protection Plan.*

☐ Microprocessor controlled port fuel injection system in the gas engine.

☒ 12 Rack and pinon steering.

☐ New body designs are dropped upside-down from three feet to verify structural analysis and strength

☐ LP gas lines routed through rubber sleeves in floor.

☐ Full-scale clay modeling assures symmetry and finish.

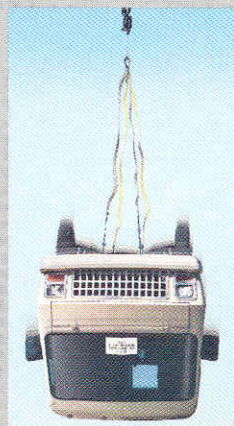

*Traveler's Protection Plan not available in Canada.

LeSharo specifications and floorplans.

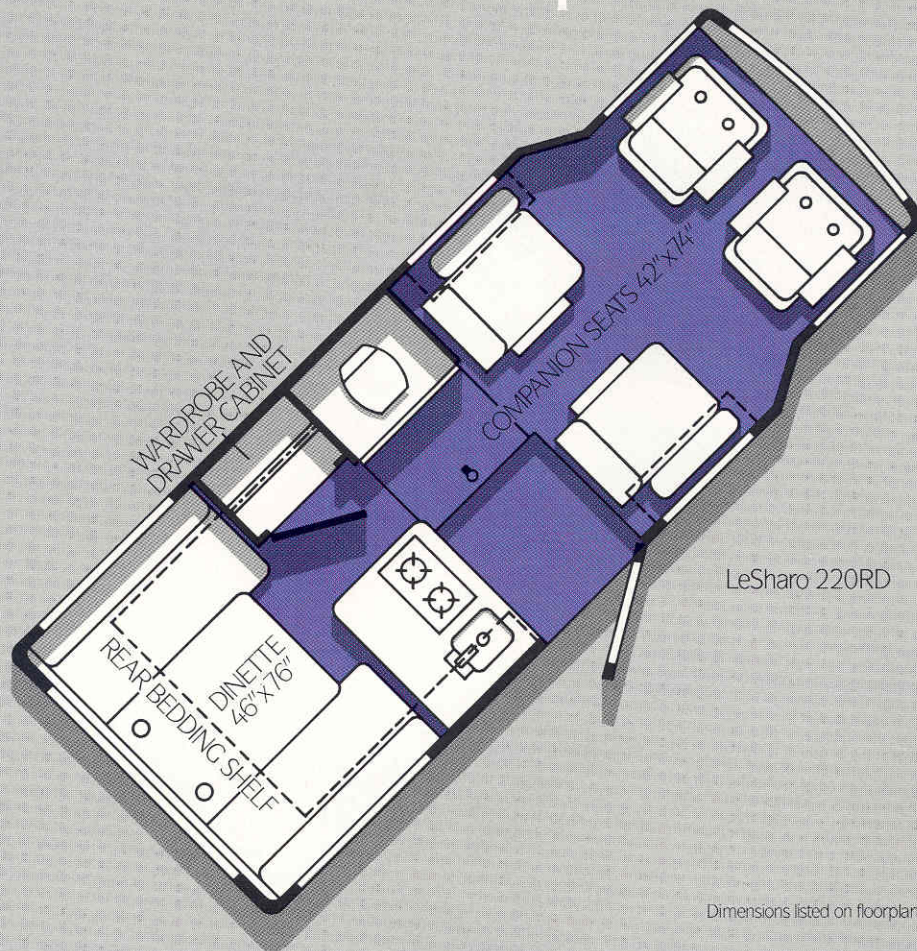

LeSharo 220RD

Dimensions listed on floorplans indicate sleeping areas.

SPECIFICATIONS

| | |
|--------------------------------------|------------------------------------------------------------------------------|
| Standard Engine* | Turbocharged 2-liter diesel w/4-speed manual transmission |
| Optional Engine | Electronic fuel-injected 2.2-liter gasoline w/3-speed automatic transmission |
| Sleeping Capacity (STD/OPT) | 4/2 in 220RD, 3/3 in 220RC |
| Length w/Spare | 207" |
| Exterior Height (w/Roof Air) | 8'1" |
| Interior height-normal | 67.6" |
| Interior height-max. | 72.4" |
| GVWR (lbs.) | 6037 Diesel 6460 Gas |
| Wheelbase | 145" |
| Fuel Capacity (gal.) | 15.5 |
| Fresh Water Capacity (gal. w/Heater) | 22 |
| Holding Tank (gal.) | 13 in 220RD, 18 in 220RC |
| LP Gas Capacity (lbs.) | 28 |

*Not available in California.

220RD STANDARD EQUIPMENT

Reclining Front Bucket Seats w/Armrests, Companion Lounge Seats w/Armrests, Convertible Dinette/Double Bed, 12-Volt Refrigerator, 2-burner Range, Stainless Steel Sink w/Dual Faucets, 6-gallon Electric Water Heater, 20,000-BTU Furnace, Full Tinted Windows, One Powered Ceiling Vent, One Non-Powered Ceiling Vent, 5-B-C Fire Extinguisher, Deluxe Monitor Panel, Double and Single Dome Ceiling Lights, Courtesy Lights, Rear Bedding Shelf, Two Recessed Beverage Holders and Ashtrays, Entrance Door Curtain, Pleated Blinds and Padded Window Valances w/Wood Trim, Silverware Drawer, Overhead Sliding Door Cabinets, Carpeting, Fold-up Lavatory, Medicine Cabinet, Toilet, Wooden Bath Door, Fold-Down Shelf w/Storage, Chrome Tissue Holder and Towel Bar, Dual Battery System, 32-Amp. Solid State Converter/Battery Charger, LP Leak Tester, Rear Mud Flaps, Lockable Water Fill Door, Rearview Mirrors (Left, Right and Interior), Sewer Hose and compartment, 110-Volt Exterior Outlet, Exterior Power Cord, Emergency Start Solenoid, Radial Tires, Front Wheel Drive, Seatbelts, Sunvisors, Spare Tire w/Carrier and Vinyl Cover, Tire Tools, Demand Water System, Electric Water Pump.

220RD OPTIONAL EQUIPMENT

Power Steering, Cruise Control, Automotive Air Conditioning, 7100 BTU Roof Air Conditioner, Rear Automotive Heater, AM/FM/Cassette Stereo, Battery Condition Gauge, Custom Steering Wheel, Passenger Visor Light, Power Door Locks, Tachometer (turbo-diesel only), Companion Bucket Seats, Front Wraparound Privacy Curtain, Screened Entrance Door, Shower Package, Running Boards, Wire Wheel Covers, Cast Alloy Wheels, Oak Beverage Tray, Engine Block Heater, Television Antenna w/Two Jacks, Locking Fuel Fill Cap, Spare Tire w/Lockable ABS Cover, Motoraid Water Heater, 2 KW Generator (gas engine vehicles only), 5 Year/50,000 Mile Traveler's Protection Plan.**

**Not available in Canada.

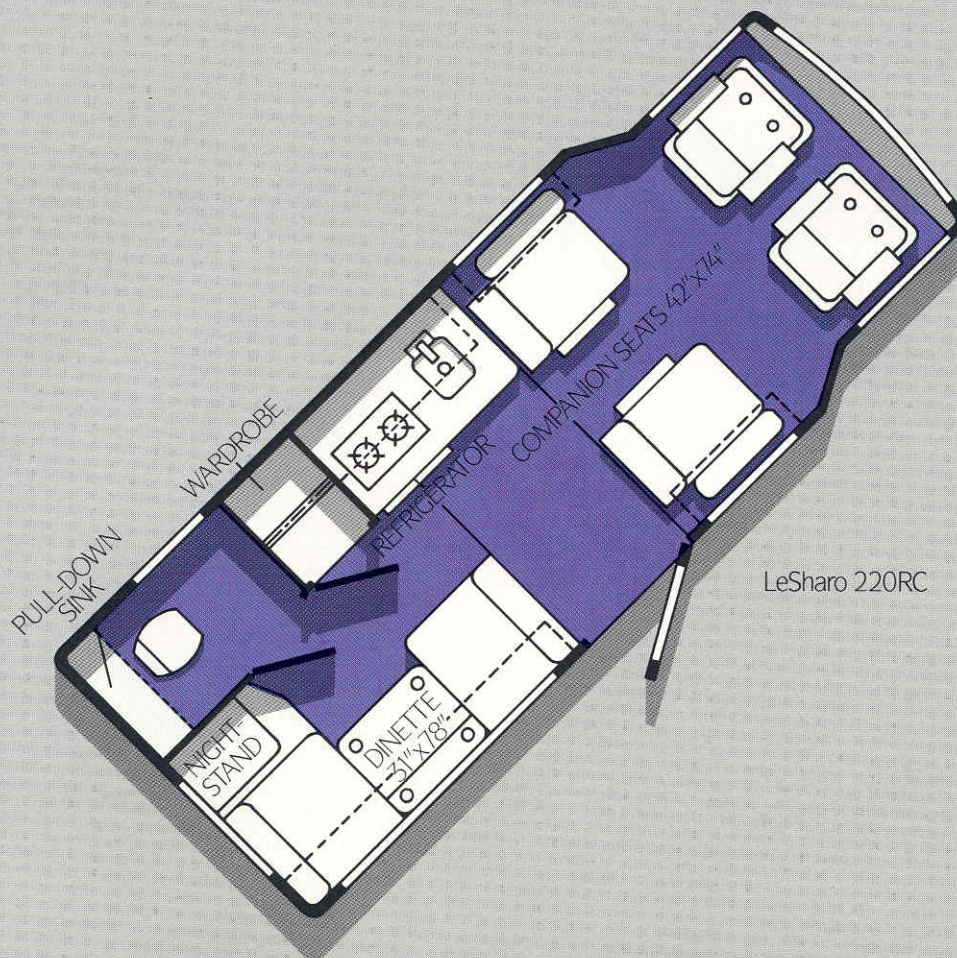

LeSharo 220RC

220RC STANDARD EQUIPMENT

Reclining Front Bucket Seats w/Armrests, Companion Lounge Seats w/Armrests, Convertible Mini-Dinette/Single Bed, 12-Volt Refrigerator, 2-Burner Range, Stainless Steel Sink w/Dual Faucets, 6-gallon Electric Water Heater, 20,000-BTU Furnace, Full Tinted Windows, One Powered Ceiling Vent, One Non-Powered Ceiling Vent, 5-B:C Fire Extinguisher, Deluxe Monitor Panel in Power Stove Vent, Double and Single Dome Ceiling Lights, Courtesy Lights, Two Recessed Beverage Holders and Ashtrays, Entrance Door Curtain, Pleated Blinds and Padded Window Valances w/Wood Trim, Overhead Cabinets w/Oak Stile and Rail Doors, Wardrobe w/Door Activated Light, Carpeting, Fold-up Lavatory, Medicine Cabinet, Toilet, Wooden Bath Door w/Full Length Mirror, Brass-Tone Tissue Holder, Towel Bar, Dual Battery System, 32-Amp. Solid State Converter/Battery Charger, LP Leak Tester, Rear Mud Flaps, Lockable Water Fill Door, Rearview Mirrors (Left, Right and Interior), Sewer Hose and Compartment, 110-Volt Exterior Outlet, 25-Foot Power Cord, Emergency Start Solenoid, Radial Tires, Front Wheel Drive, Seatbelts, Sunvisors, Spare Tire w/Carrier and Wheel Cover, Tire Tools, Demand Water System, Electric Water Pump.

220RC OPTIONAL EQUIPMENT

Power Steering, Cruise Control, Automotive Air Conditioning, 7100 BTU Roof Air Conditioner, Rear Automotive Heater, AM/FM/Cassette Stereo, Electronic Tuning AM/FM/Cassette Stereo, Battery Condition Gauge, Custom Steering Wheel, Passenger Visor Light, Power Door Locks, Tachometer (turbo-diesel only), Companion Bucket Seats, Front Wraparound Privacy Curtain, Screened Entrance Door, Room Divider Curtain, Lavatory Skylight, Running Boards, Wire Wheel Covers, Cast Alloy Wheel Covers, Oak Beverage Tray, Engine Block Heater, Television Antenna w/Two Jacks, Locking Fuel Fill Cap, Spare Tire w/Lockable ABS Cover, Motoraid Water Heater, 5 Year/50,000 Mile Traveler's Protection Plan.**

**Not available in Canada.

JOIN THE W.I.T. CLUB.

W.I.T. stands for the Winnebago International Travelers Club. It's one of the best ways to make your new Winnebago an even more exciting motor home to own.

By joining the W.I.T. Club, you become part of a fellowship which is specially committed to sharing the fun of owning a Winnebago motor home.

You'll be invited to rallies and caravans across the U.S., Canada and Mexico, receive special services and discount opportunities and, of course, enjoy the unique camaraderie of motor homing with others who, like you, have discovered the excitement of traveling in a Winnebago motor home.

Ask your dealer for details.



For Winnebago sales and service, contact:



Be sure it's a Winnebago